

**UNOBSTRUCTED SIGHT DISTANCE**

Section 2.09, sub-section A.4

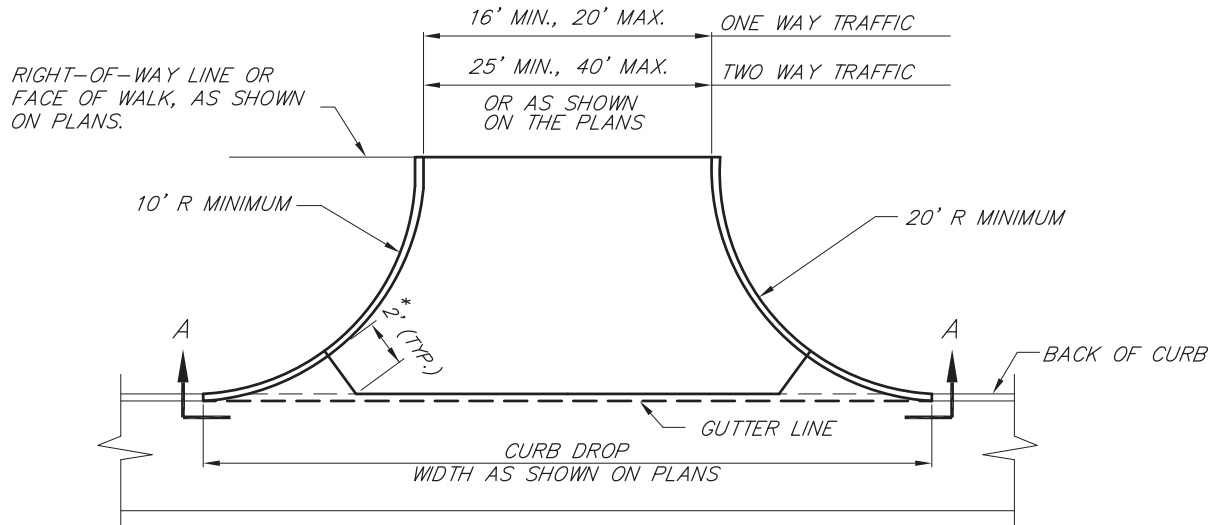

~~\* 4' FOR ASPHALT DRIVE PAVEMENT~~

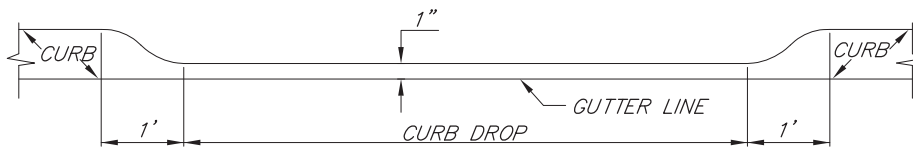

SECTION A-A  
NOT TO SCALE

**NOTES:**

CONSTRUCT THE DRIVE APPROACH WITH 8" NON-REINFORCED CONCRETE ON 6" OF 21AA AGGREGATE BASE COURSE COMPACTED IN PLACE (CIP) ~~OR 6" HMA LEVELING ON 9" OF 21AA AGGREGATE BASE COURSE (CIP).~~

CURBS SHALL BE CONSTRUCTED WITH HEIGHT VARYING FROM 6" AT BACK OF CURB TO 0" HEIGHT AT FACE OF SIDEWALK OR RIGHT-OF-WAY LINE.

AT ALL CONCRETE DRIVES, PLACE A 1" EXPANSION JOINT AT BACK OF CURB AND 1/2" EXPANSION JOINT AT FACE OF SIDEWALK OR RIGHT-OF-WAY LINE. MAINTAIN NORMAL SIDEWALK GRADE ACROSS DRIVE, 2% SLOPE UP FROM FACE OF SIDEWALK.

INBOUND OR OUTBOUND RADIUS SHALL BE REDUCED TO 5' FOR ONE-WAY TRAFFIC DRIVE APPROACH.

DRIVE APPROACH SHALL NOT ENCROACH ACROSS PROPERTY LINE EXTENDED WITHOUT WRITTEN APPROVAL FROM THE ADJOINING PROPERTY OWNER.

WORK THIS SHEET WITH ~~THE GENERAL NOTES ON RS-1 AND D-6 SHEET 2-2.~~

REVISION DATE: 08/01/07
DIRECTOR OF ENGINEERING
DIVISION PERMIT ENGINEER

WAYNE COUNTY DEPARTMENT OF PUBLIC SERVICES  
ENGINEERING DIVISION/PERMIT OFFICE  
PERMIT STANDARDS  
**COMMERCIAL DRIVE APPROACH**

SCALE NOT TO SCALE
<b>D-6</b>
SHEET 1 OF 2

# CURB RETURN JOINING EXISTING PAVEMENT

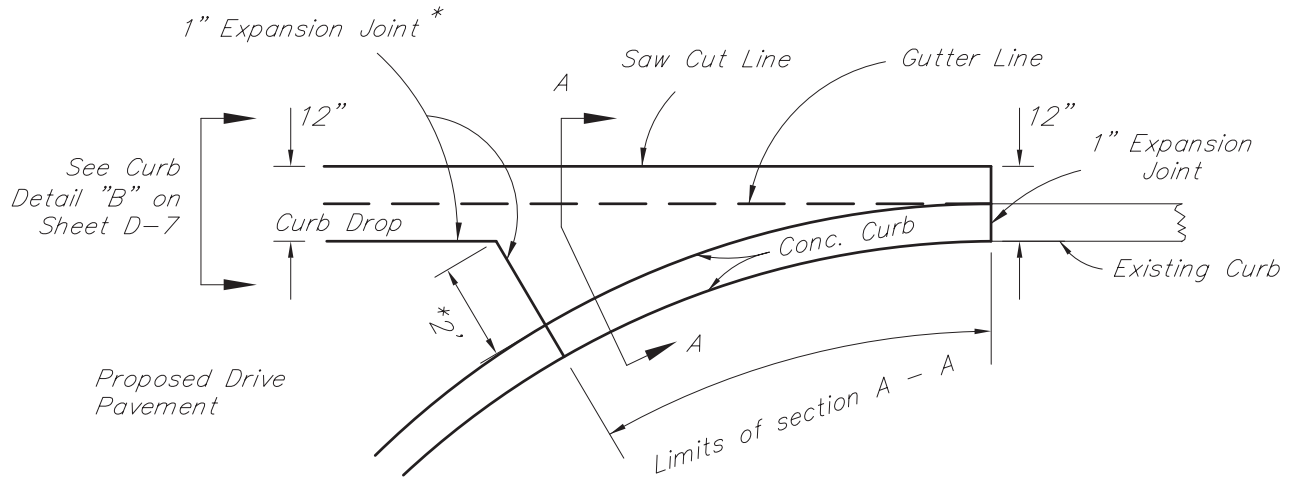

~~\* 1' for HMA Drive Pavement. No Expansion Joint Required.~~

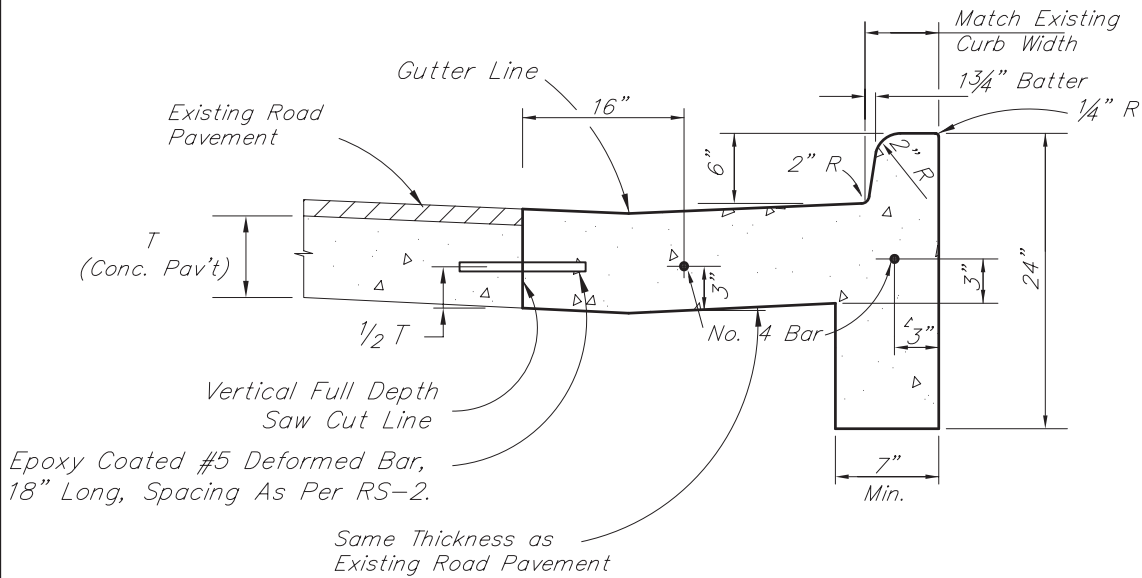

Section "A - A"

~~WORK THIS SHEET WITH THE GENERAL NOTES ON RS-1.~~

REVISION DATE: 08/01/07	WAYNE COUNTY DEPARTMENT OF PUBLIC SERVICES ENGINEERING DIVISION/PERMIT OFFICE PERMIT STANDARDS	SCALE NOT TO SCALE
_____ DIRECTOR OF ENGINEERING	<b>COMMERCIAL DRIVE APPROACH</b>	<b>D-6</b>
_____ DIVISION PERMIT ENGINEER		SHEET 2 OF 2